



Gorleston, Great Yarmouth, Norfolk, NR31 8BG

£170,000

🛏️ 2 🚿 1 🚗 1



- Detached Park Home Bungalow
- Small Residential Park
- Close To Local Amenities
- New Roof Fitted 2012
- Enclosed Rear Garden
- Two Double Bedrooms
- Close To The Coast
- Home Extensively Rebuilt 2005 to 2007
- Driveway Parking
- Viewing Recommended



A well presented two double bedroom detached park home bungalow situated on this small residential park for the over 55's. Located close to the coast and close to local amenities this home not only offers a terrific location but the home has undergone extensive refurbishment and rebuilding between 2005 and 2007 and a further addition of a new roof in 2012. The home is bright and airy and offers a lounge/dining room measuring over 17ft in length, a modern, fitted kitchen, two bedrooms, a modern fitted bathroom, double glazing and the addition of air conditioning units in the home Externally there is a blocked paved driveway to the side and an enclosed, easy to maintain rear garden with a generous storage shed included.

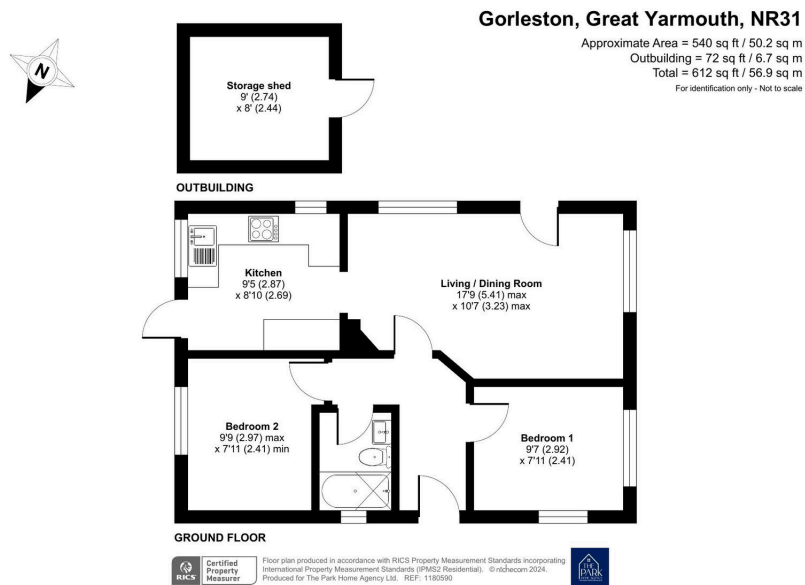

01793 230185
 sales@theparkhomeagency.co.uk

Agents Notes: All measurements are approximate and quoted in metric with imperial equivalents and for general guidance only and whilst every attempt has been made to ensure accuracy, they must not be relied on. The fixtures, fittings and appliances referred to have not been tested and therefore no guarantee can be given that they are in working order. Internal photographs are reproduced for general information and it must not be inferred that any item shown is included with the property. For a free valuation, contact the numbers listed on the brochure